

Kali

Collaborative Project 2023-2024

A Portable Potassium Monitoring Solution



Clinical Leads

Dr Shazia Adalat - Consultant Nephrologist

Academic Lead

Gabriella Spinelli

Design Student

Sophia Kambouris



Brunel
University
London



The Challenge

Millions of people worldwide suffer from imbalanced potassium levels which pose serious health risks including seizures, heart attacks and greater all-cause mortality.

Currently, the only way to test your potassium levels is through booking an in-person blood test at hospitals or GPs; the process which suffers from delays and poor communication issues – with individuals waiting up to 7 days to receive test results.

Individuals with potassium imbalances are often living with lifelong conditions which they can only manage with lifestyle changes, treatment plans and dietary adjustments.

The inability to monitor one's potassium levels leaves patients in the dark and forces them to rely on estimates. In addition, individuals often miss out on normal daily activities attending appointments and avoiding strenuous situations for fear of worsening their condition.

Product Requirements

- Improve quality of life for patients with potassium imbalances
- Improve accuracy of the patients' healthcare plan
- Provide patients with more independence in their daily lives

Ideation and Development

Physical form development and ideation



Ideation and Development Cont.

Key User Flows for Digital User Experience Interaction

User Onboarding

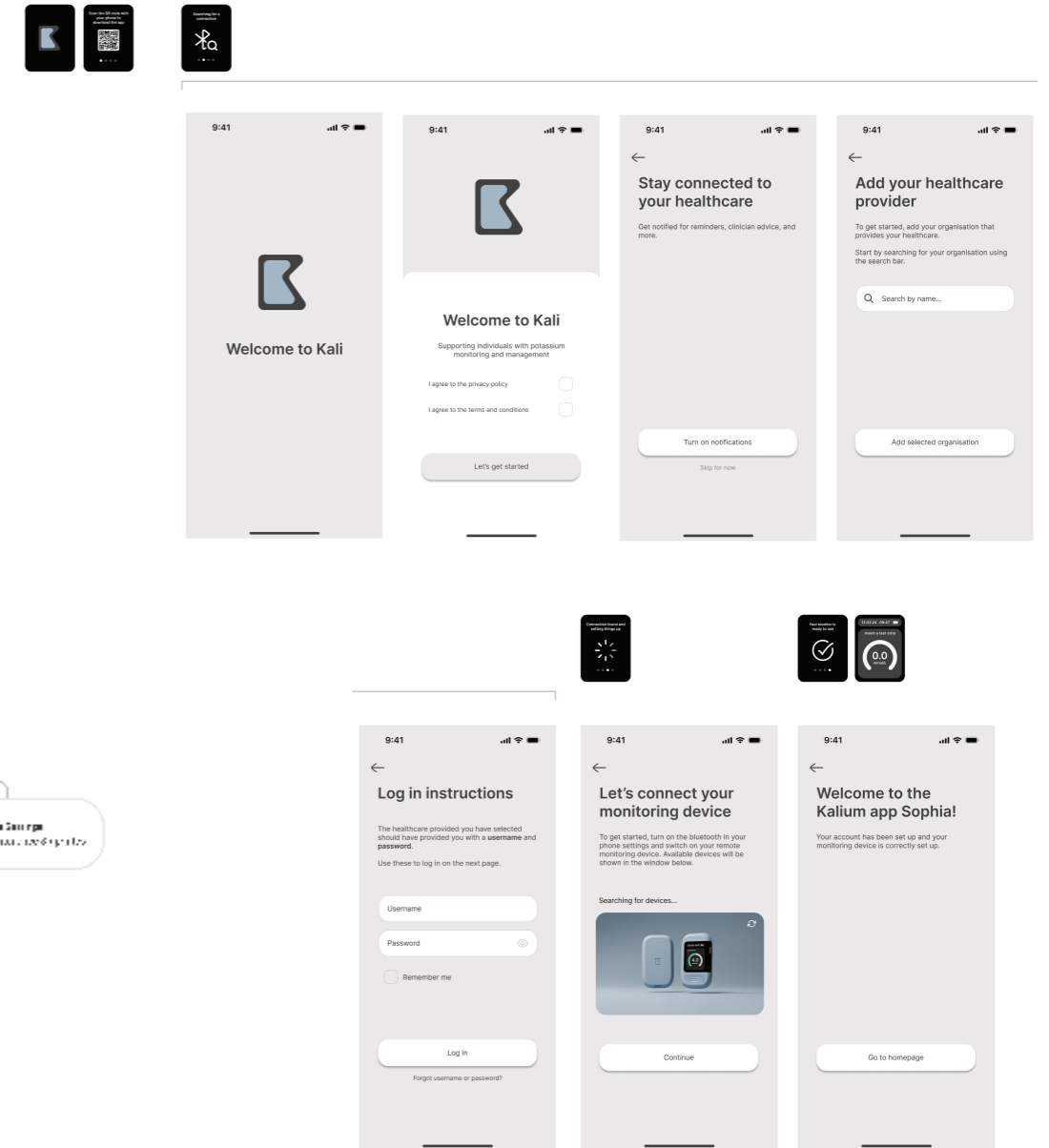
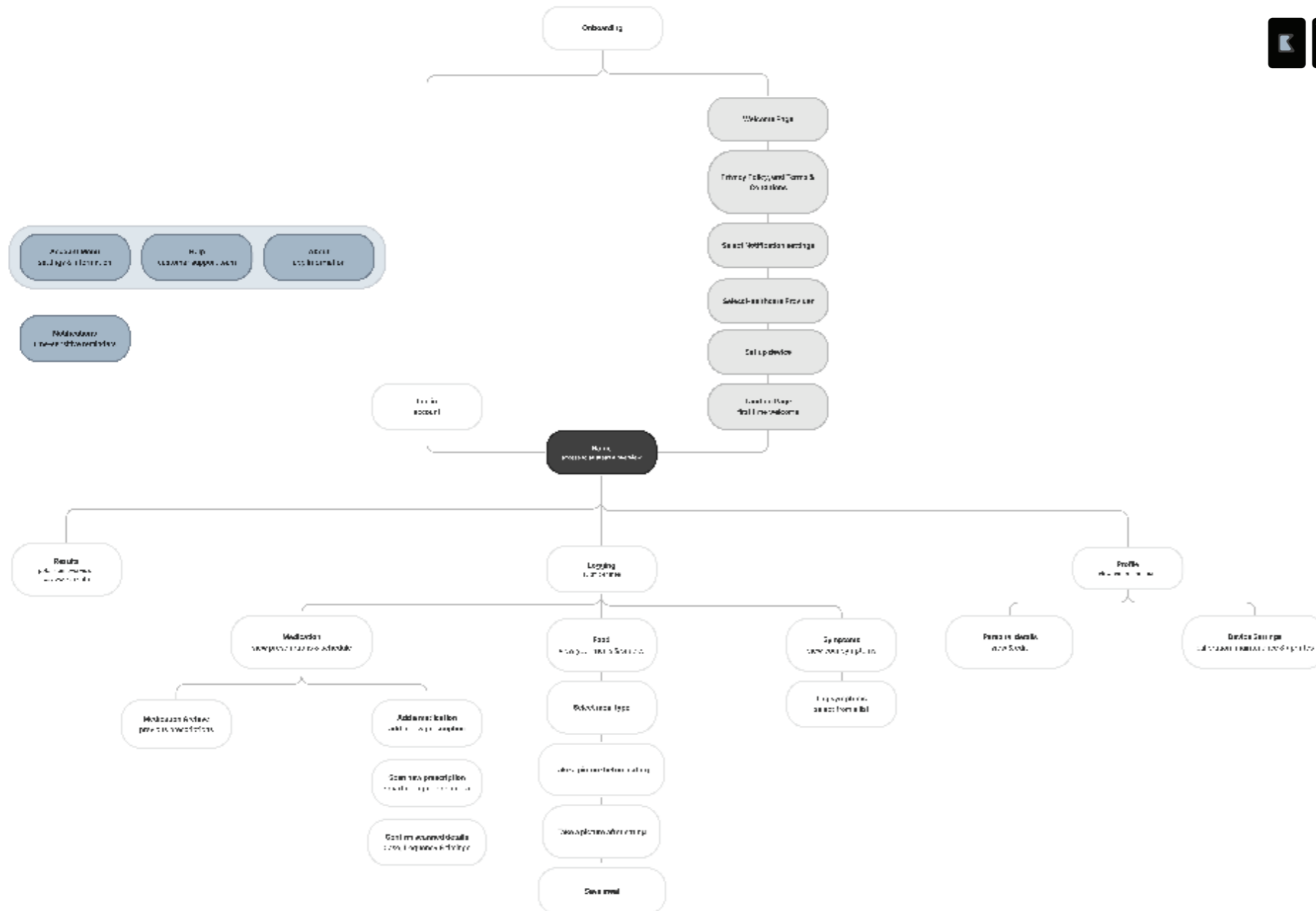

Final Prototype



Device UI

Date, Time, Battery Indication
Testing Instruction
Real-time test results



Interaction Button

Long Press - Power on/off

Short Press - System Navigation



Test strip slot

features automated test strip detection



USB-C Charging

Final Prototype Cont.

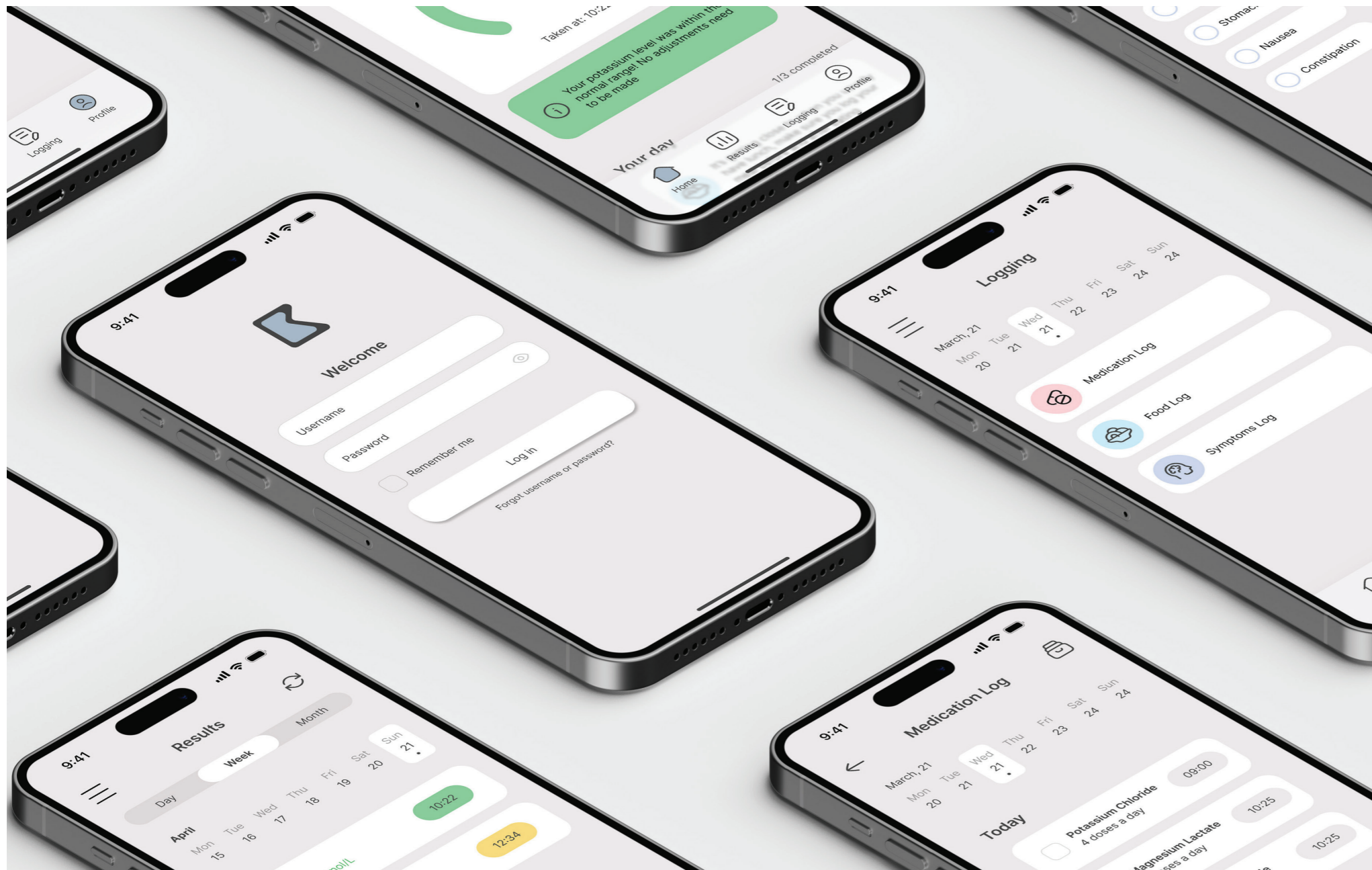

**"It's just worth having the actual dose on there, just so that it's crystal clear what they should be on."
User #5**

**'It's gonna be a lot more manageable for people. Fantastic. A lot less stress'.
User #3**

100%
Users would use the system upon release